

Public Meeting 4th Feb 2015

Development in Lyonshall

Background

- Specific Proposals Now
- How the full plan might evolve
- Pros / Cons
- What other plans are around?
- Qs & As - Kinsey
 - Full Plan status
 - Tangible benefits to the parish
 - Money
 - Timing outlines

Specific Proposals now

- How many?
- Where?
- When?
- Additional works
 - Holme Marsh Connection
 - Spond Lane
- Where to see the detail?

Sites

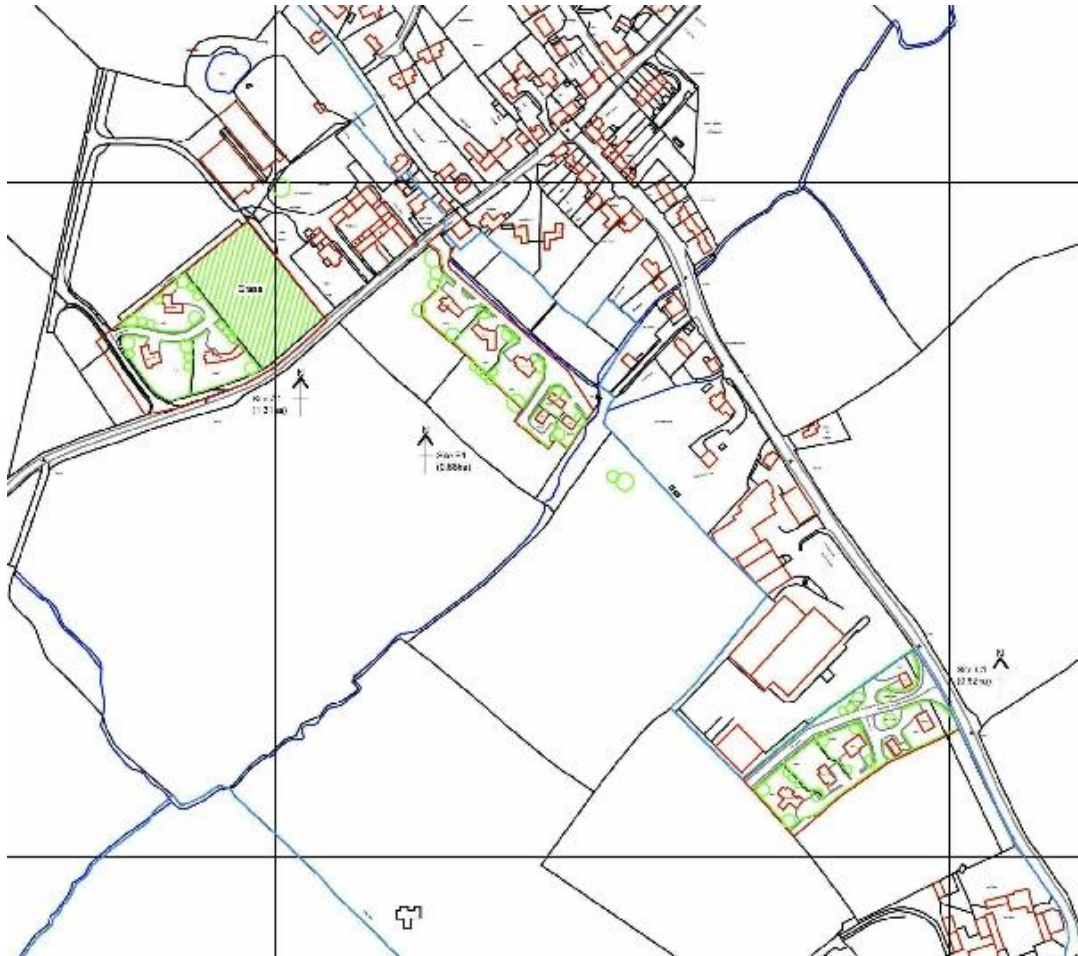

Houses - examples



Houses - examples





Weald Manor
 Ground Floor 129.3sq.m
 First Floor 131.4sq.m
 Total 260.7sq.m



Woodhouse
 Ground Floor 124.7sq.m
 First Floor 127.3sq.m
 Total 251sq.m



Kempley
 Ground Floor 141.2sq.m
 First Floor 142.3sq.m
 Total 282.5sq.m



Frittenden
 Ground Floor 114.7sq.m
 First Floor 112.5sq.m
 Total 227.2sq.m

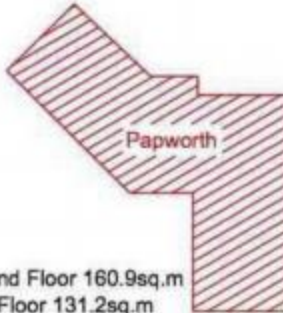

Papworth
 Ground Floor 160.9sq.m
 First Floor 131.2sq.m
 Total 292.1sq.m



Sommerville House
 Ground Floor 118sq.m
 First Floor 107.3sq.m
 Total 225.3sq.m



2 Bed
 Ground Floor 55.9sq.m
 Total 55.9sq.m



3 Bed
 Ground Floor 54sq.m
 First Floor 44.4sq.m
 Total 98.4sq.m



Banaszkiewkz
 Ground Floor 146.7sq.m
 First Floor 116.7sq.m
 Total 263.4sq.m



Farrell Price
 Ground Floor 100sq.m
 First Floor 74.6sq.m
 Total 174.6sq.m



Barn 1
 Ground Floor 81.4sq.m
 First Floor 50.9sq.m
 Total 132.3sq.m



Orchard House
 Ground Floor 95.2sq.m
 First Floor 95.2sq.m
 Total 190.4sq.m

Relevant documents

▶ [Application Form \(1\)](#)

▼ [Supporting Documents \(11\)](#)

- [R Utilities Assessment](#) 13.9MB
- [Site C Flood Risk Assessment & Drainage Strategy](#) 27.1MB
- [Site B Flood Risk Assessment & Drainage Strategy](#) 28.4MB
- [Site A Flood Risk assessment & Drainage Strategy](#) 28.4MB
- [Ecological Assessment](#) 18.1MB
- [Transport Statement](#) 14.7MB
- [Sewage Treatment Plant](#) 459KB
- [House Property Details](#) 233KB
- [Design & Access Statement](#) 2.1MB
- [Archaeology Summary Report](#) 2.6MB
- [Landscape & Visual Appraisal](#) 21.5MB

▼ [Drawings \(17\)](#)

- [Three Bay Highgrove 3 Bed Mirrored - Ground & First Floor Plans](#) 341KB
- [Three Bay Highgrove 3 Bed Mirrored - Elevations](#) 595KB
- [Orchard House - Ground & First Floor Plans](#) 387KB
- [Orchard House - Elevations](#) 1.3MB
- [Three Bay Highgrove 2 Bed - Ground Floor Plan](#)

The Full Plan

- How many?
- Where?
- When?
- Additional works
- Money / Village Centre fund

Pros / Cons

- Listed in the briefing document
- Weigh up which are important to us
- Risks – what happens if the whole plan doesn't go ahead? Which pros and cons are still valid?

What Other plans?

- Two possibles:-
 - Charity's field opposite The Close
 - White Lion Meadow

- Each about 7 houses, well spaced, both in pre-planning stage, no concrete applications yet, timing unclear.

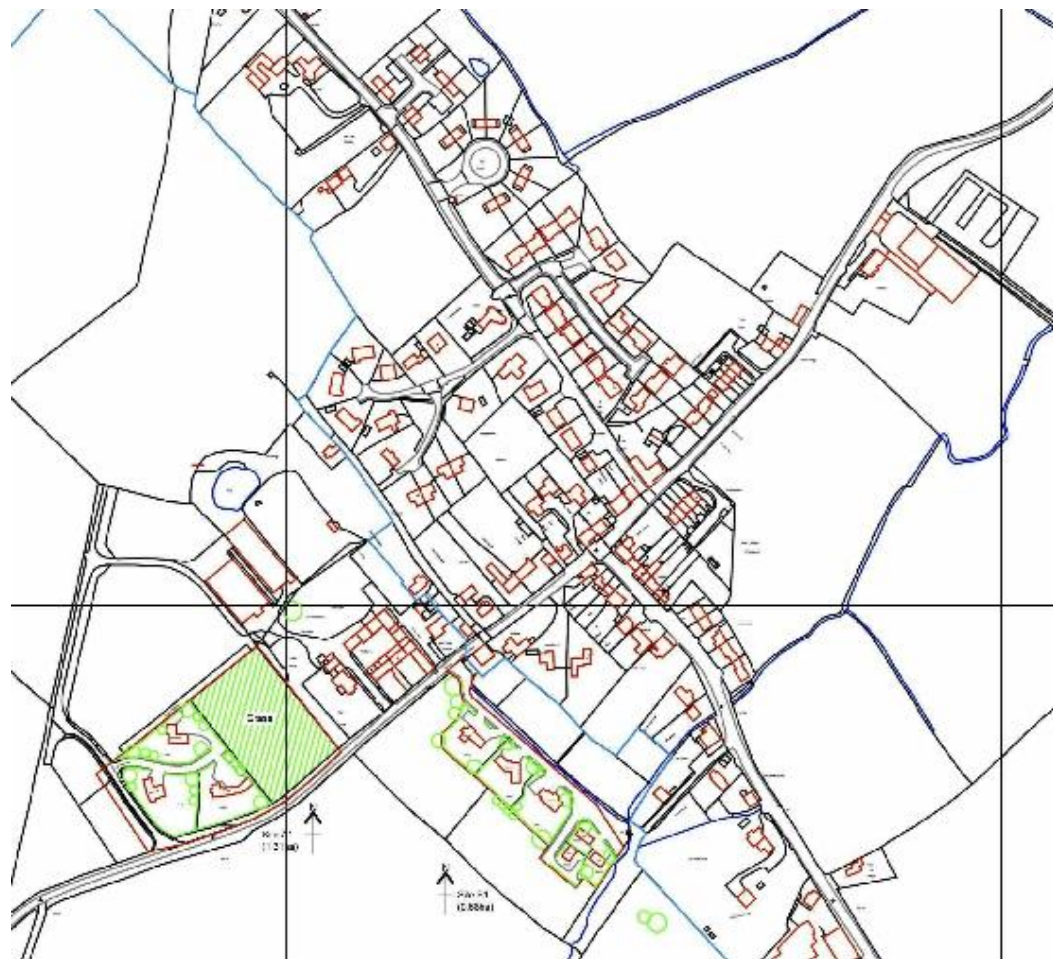

Qs & As

- Qs & As - Kinsey
 - Full Plan status
 - Tangible benefits to the parish
 - Money
 - Timing outlines
 - First 15
 - Subsequent houses